

Labilis Wall

DESIGN | PAOLO CASTELLI

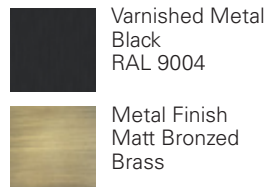

Finishes of the above picture



Tre anelli di diverso diametro installabili a parete singolarmente o in composizione libera. L'anello in metallo è finitura nero opaco con diffusore di luce led in policarbonato opalino bianco perimetrale. Ogni anello è fissato a parete da un cilindro metallico in finitura bronzo ottone opaco e da due distanziatori in metallo finitura nero opaco. Alimentatore remoto. Optionals su richiesta: anelli dimmerabili.

Three rings of different diameters that can be installed on the wall individually or in random composition. The metal ring has a matt black finish with a white opal polycarbonate LED light diffuser around the perimeter. Each ring is fixed to the wall by a metal cylinder in matt brass bronze finish and by two metal spacers in matt black finish. Remote power supply. Optionals on request: dimmable rings.

RING Ø27

TECHNICAL SHEET LABILIS Ø27
Light source: Strip Led 140 Led/m
Total power: 7,3W - Strip led 14,4W/m
Voltage: 230 V
Rated luminous flux strip led: 1092 Lm
Colour temperature: 2700°K
Colour rendering index: 90
Dimmer function: Yes
Weight: Kg 3

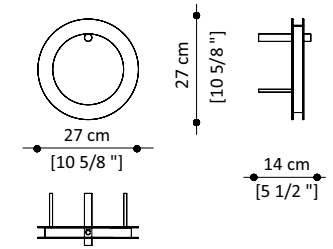

WALL RING Ø27 | ILL.LABI.530

1 ring Ø27 in metal matt black varnished. Metal cylinder in matt bronzed brass
Remote drivers

RING Ø43

TECHNICAL SHEET LABILIS Ø43
Light source: Strip Led 140 Led/m
Total power: 9,7W - Strip led 14,4W/m
Voltage: 230 V
Rated luminous flux strip led: 1755 Lm
Colour temperature: 2700°K
Colour rendering index: 90
Dimmer function: Yes
Weight: Kg 4

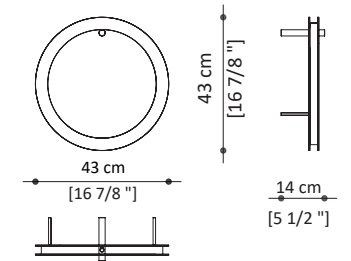

WALL RING Ø43 | ILL.LABI.520

1 ring Ø43 in metal matt black varnished. Metal cylinder in matt bronzed brass
Remote drivers

RING Ø70

TECHNICAL SHEET LABILIS Ø70
Light source: Strip Led 140 Led/m
Total power: 13,6W - Strip led 14,4W/m
Voltage: 230 V
Rated luminous flux strip led: 2857 Lm
Colour temperature: 2700°K
Colour rendering index: 90
Dimmer function: Yes
Weight: Kg 6

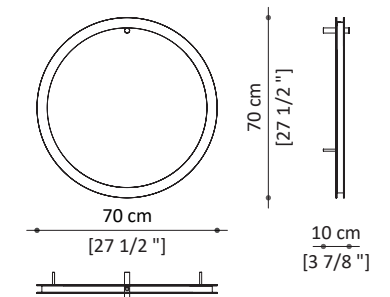

WALL RING Ø70 | ILL.LABI.510

1 ring Ø70 in metal matt black varnished. Metal cylinder in matt bronzed brass
Remote drivers



Labilis

Wall

DESIGN | PAOLO CASTELLI



Finishes of the above picture

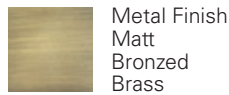

Tre anelli di diverso diametro installabili a parete singolarmente o in composizione libera. L'anello in metallo è finitura nero opaco con diffusore di luce LED in policarbonato opalino bianco perimetrale. Ogni anello è fissato a parete da un cilindro metallico in finitura bronzo ottone opaco e da due distanziatori in metallo finitura nero opaco. Alimentatore remoto. Optionals su richiesta: anelli dimmerabili.

Three rings of different diameters that can be installed on the wall individually or in a random composition. The metal ring has a matt black finish with a white opal polycarbonate LED light diffuser around the perimeter. Each ring is fixed to the wall by a metal cylinder in matt brass bronze finish and by two metal spacers in matt black finish. Remote power supply. Optionals on request: dimmable rings.

Ø27

TECHNICAL SHEET

LABILIS Ø27

Light source: Strip LED 140 LED/m
Total power: 7,3W - Strip LED 14,4W/m
Voltage: 230V
Rated luminous flux strip LED: 1092 lm
Colour temperature: 2700°K
Colour rendering index: 90
Dimmer function: Yes
Weight: Kg 3

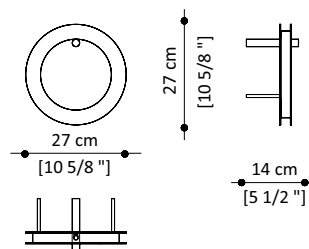

WALL RING Ø27 | ILL.LABI.530

1 ring Ø27 in metal matt black varnished. Metal cylinder in matt bronzed brass. Remote drivers

Ø43

TECHNICAL SHEET

LABILIS Ø43

Light source: Strip LED 140 LED/m
Total power: 9,7W - Strip LED 14,4W/m
Voltage: 230V
Rated luminous flux strip LED: 1755 lm
Colour temperature: 2700°K
Colour rendering index: 90
Dimmer function: Yes
Weight: Kg 4

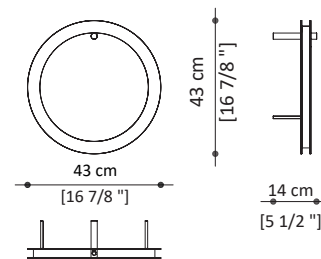

WALL RING Ø43 | ILL.LABI.520

1 ring Ø43 in metal matt black varnished. Metal cylinder in matt bronzed brass. Remote drivers